

**Priced From****\$261,990****1 Exterior Styles Available** **2,158+ Sq. Ft.** **4 Bedrooms** **2.5 Bathrooms** **2 Car Garage**

The Fairview is a spacious 4-bedroom, 2.5-bath home that blends open-concept living with thoughtful design. It's become a favorite among homeowners—so much so that we made it one of our model homes!

The first floor keeps conversations flowing with a seamless layout connecting the kitchen, breakfast room, and great room. Staggered-height cabinets, granite countertops, a sleek pull-out faucet, and stainless steel appliances make the kitchen both stylish and functional. A beaded garage door and decorative front door add curb appeal, while inside, natural light and modern finishes create a warm and inviting atmosphere.

Upstairs, the primary suite is a true retreat with a private bath, raised-height vanity with granite tops, and a spacious walk-in closet. The versatile loft is perfect for a homework station, reading nook, or even an additional great room. Plus, you have the option to move the utility room upstairs for added convenience!

What sets the Fairview apart? This home includes many of our most popular personal choice options—on top of the great features included in most of our homes. Come explore the Fairview and see why so many homeowners are falling in love with this plan!



All square footage is approximate. Renderings are artist's conceptions and may vary slightly from the actual home. Homes may be built in reverse of plans shown, depending on site conditions. Minor architectural changes may be made occasionally at the option of the builder. Please contact your Sales Consultant for details.

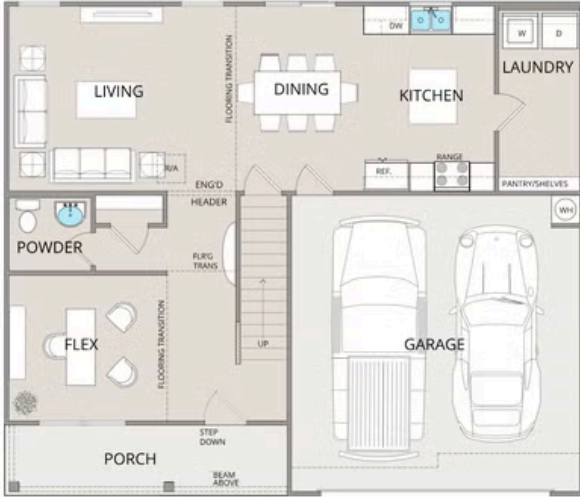

MAIN



UPPER

All square footage is approximate. Renderings are artist's conceptions and may vary slightly from the actual home. Homes may be built in reverse of plans shown, depending on site conditions. Minor architectural changes may be made occasionally at the option of the builder. Please contact your Sales Consultant for details.